



# Engineering eJob 7/11/2018

## Table of Contents

Page No.	Truss Label	Page No.	Truss Label	Page No.	Truss Label
1	T01	2	T02		

Page 1

Alpine, a division of ITW Building Components Group Inc.  
2820 N. Great Southwest Pkwy.  
Grand Prairie, TX 75050  
800-521-9790



## Engineering eJob 7/11/2018

This eJob is prepared exclusively for:

Timberline Truss (6952)  
PO Box 148

Newman Lake, WA 99025

Work Order: 23419  
Job Customer: ZIGGY NP  
Job Name: 008-862199 JOINT FIRE PROTECTION  
Job Address: 25266 HWY 395 N  
KETTLE FALLS WA 99141

Alpine ID: T599890.J629394

I hereby verify that this document was prepared by me or under my direct supervision and that I am a duly Licensed Professional Engineer. I am responsible for the design of each component detail only -- not for the proper manufacture of the components.

This document is no longer valid if any modifications are made to it.

Alpine, a division of ITW Building Components Group Inc.  
2820 N. Great Southwest Pkwy.  
Grand Prairie, TX 75050  
800-521-9790







## Engineering eJob 7/11/2018

**Required Details\***

**Other Available Details\***

<http://www.itwbcg.com/trussconnections.php>

**\*Sealed versions of these details are available upon request.**

Alpine, a division of ITW Building Components Group Inc.  
2820 N. Great Southwest Pkwy.  
Grand Prairie, TX 75050  
800-521-9790



## Engineering eJob 7/11/2018

### Truss Engineer Design Responsibilities

The engineer's signature on this design certifies that the individual component depicted, if built with the materials and to the placements and tolerances specified, will bear the loads shown on the drawing. Users of the component are responsible for determining that any as-built component conforms to the design. The loading and dimensions specified have been provided by others and have not been verified by the signing engineer. The building designer is responsible for determining that the dimensions and loads for each component match those required by the plans and by the actual use of the individual component. The building designer is responsible for ascertaining that the loads shown on the designs meet or exceed applicable building code requirements and any additional factors required in the particular application. The engineer's seal on the attached component designs indicates acceptance of professional engineering responsibility solely for the design of the individual component assuming that the loading and dimension requirements are as represented to the engineer. The suitability and use of this component for any particular building is the responsibility of the building designer in accordance with ANSI/TPI 1 Chapter 2. The engineer certifying this component is not responsible for anything beyond the specific scope of work set forth above, including but not limited to, the loading factors used in the design of the component, the dimensions of the component, the transfer of lateral loads from the roof and/or forward to the shear walls down to the foundation, connection of the components to the bearing support, the design of the bearing supports, the design and connection to the shear walls, the design of temporary or permanent building bracing required in the roof and/or floor systems, transfer of vertical loads down to the foundation, the design of the foundation or analysis in connection with the roof and/or floor diaphragms of the building. This is a high quality facsimile of the original engineering document. A wet or embossed seal copy of this engineering document is available upon request.

Alpine, a division of ITW Building Components Group Inc.  
2820 N. Great Southwest Pkwy.  
Grand Prairie, TX 75050  
800-521-9790

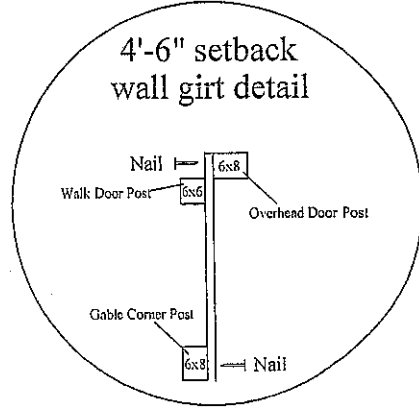
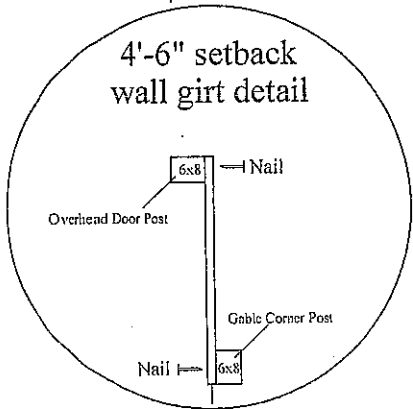
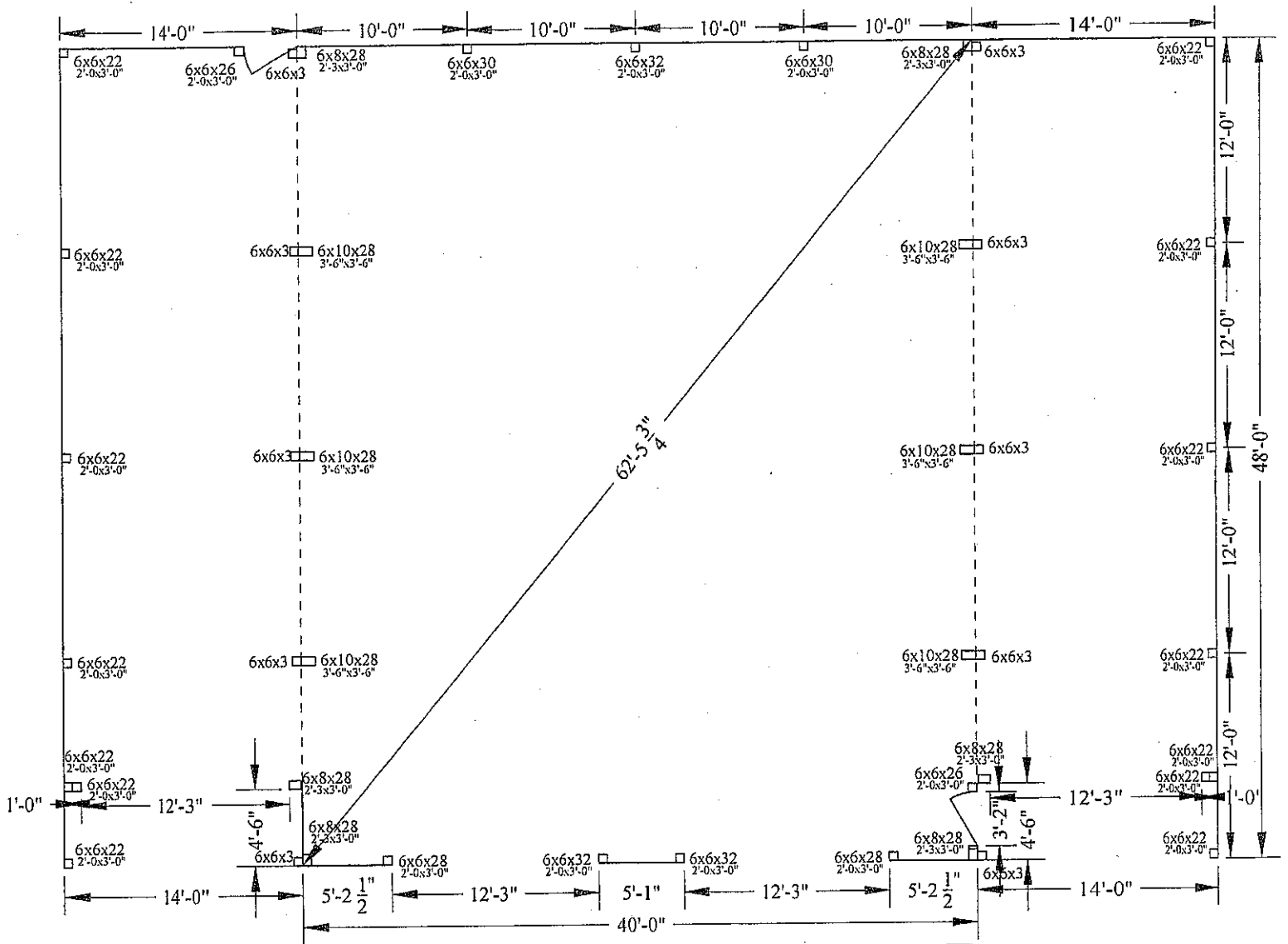

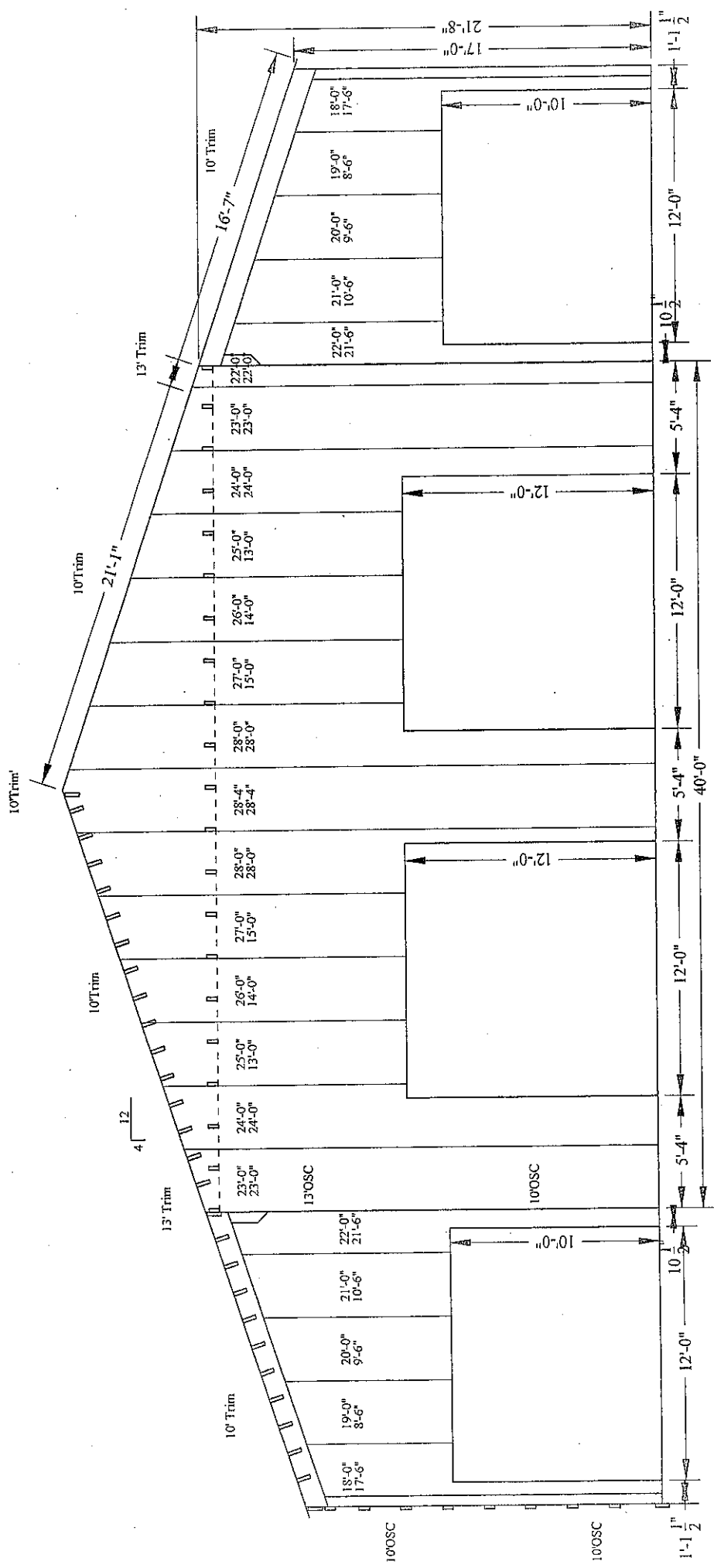



Roof Sheathing = 108 Total Sheets

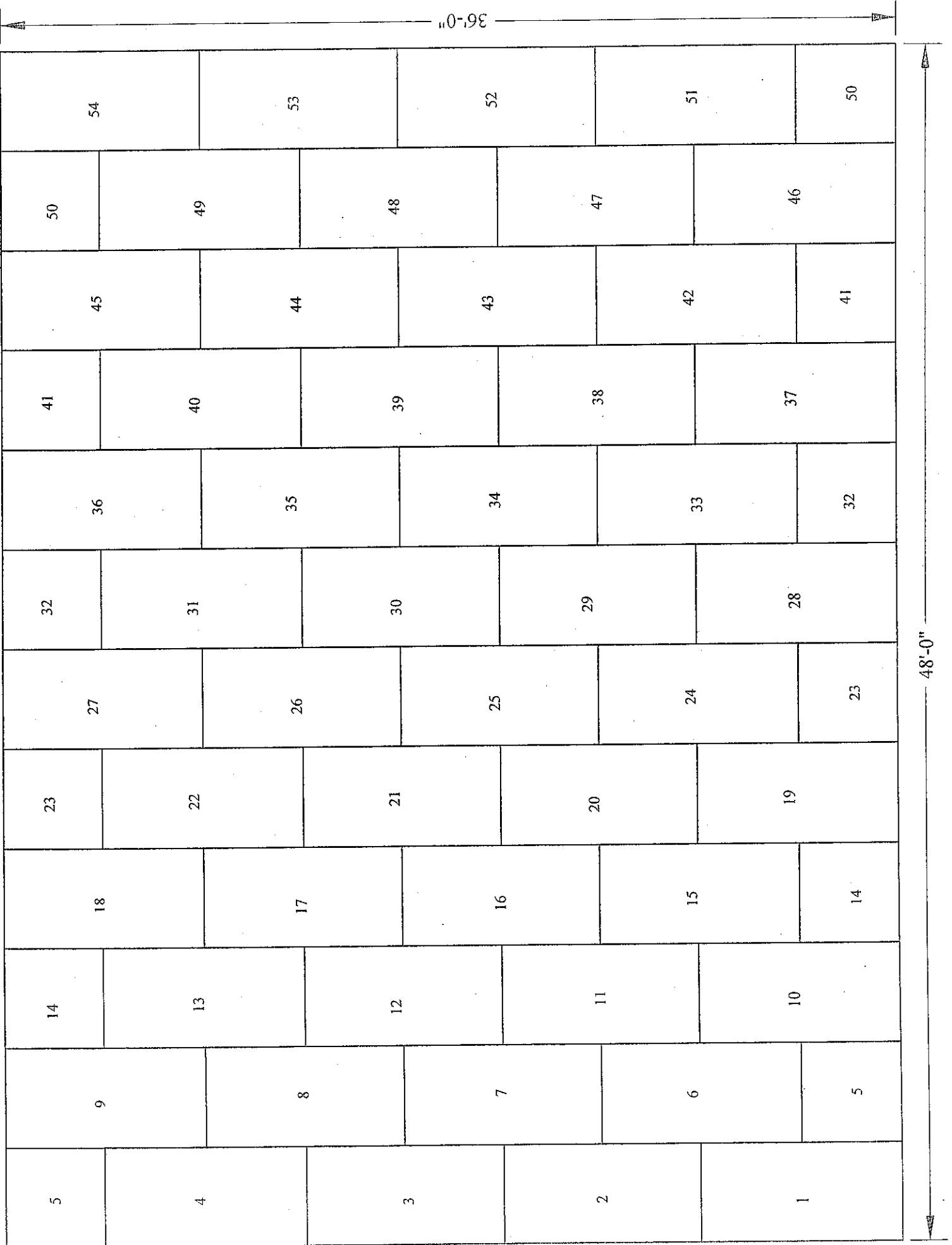

Customer  
Address  
City, State Zip  
Phone

Joint Fire Protection Dist  
25266 Hwy 395 N  
Kettle Falls, WA 99141  
360-402-7295

**40x48x21'8 Kit Pole Building 008-09145**  
**Take Off Done By Central**

Treated Posts	Qty Eavewall	Qty Corners	Qty Gable
6x6x26T	1		
6x6x28T			2
6x8x28T		4	
6x10x28	6		
6x6x30			2
6x6x32			3
<b>Treated Bottom Girts</b>			
	<b>Eavewall</b>	<b>Gable</b>	
2x8x10T	1	5	
2x8x12T		1	
<b>Wall Girts</b>			
<b>Descript</b>	<b>Eavewall</b>	<b>Gable</b>	
2x6x10	7	40	
2x6x12		15	
2x6x14		12	
<b>Top Wall Girts</b>			
	<b>Eavewall</b>		
2x8x12	8		
<b>Gable Corner Blocking</b>			
	<b>Gable</b>		
2x6x12	8		
<b>Walk Door / Window Blocking</b>			
	<b>Eavewall</b>	<b>Gable</b>	
2x6x12	3		
<b>Web Bracing</b>			
	<b>Qty</b>		
2x4x12	2		
2x10x12	3		
<b>Rough Cut Blocking</b>			
2x6x12	12		
<b>Truss Blocking</b>			
	<b>Qty</b>		
2x10x12	3		
<b>Truss Hardware</b>			
	<b>Qty</b>		

**Customer** Joint Fire Protection Dist  
**Address** 25266 Hwy 395 N  
**City, State Zip** Kettle Falls, WA 99141  
**Phone** 360-402-7295

---

2x8 Joist	256
10.5" Bolts	18
3/4" Nut	18
3/4" Wash	36

Roof Framing

	Qty
2x8x12	134

Walk Door

	Qty
Door Shims	1
3/0 6-Pnl STL LH	1
Combo	1

Overhead Doors

	Qty
Slide Latch	2
Punch Angle	8
2x8x12	4
2x8x14	2
2x10x14	2

Misc Inside

	Qty
2x6 Joist Hangers	152
2x6x12	84

Misc Roofing

	Qty
4x8x15/32 Wafer	110
Synth Roof Underlay 10SQ	4

Lean-To Treated Posts	Qty Eavewall	Qty Corners	Qty Gable
6x6x16T	2		
6x6x22	8	4	2
6x8x28	2		
6x6x26			1

Lean-To Treated Bottom Girts	Eavewall	Gable
2x8x8T		1
2x8x12T	8	
2x8x16T		4

Lean-To Wall Girts	Eavewall	Gable
2x6x12	66	
2x6x16		22

<b>Customer</b>	Joint Fire Protection Dist
<b>Address</b>	25266 Hwy 395 N
<b>City, State Zip</b>	Kettle Falls, WA 99141
<b>Phone</b>	360-402-7295

---

**Lean-To Top Wall Girts**

	Eavewall
2x8x12	8

**Lean-To Roof Rafters**

	Qty
1x4x16	4
1 3/4"x11 7/8" LVL	256
Cut 16 @ 16'	1

**Lean-To Roof Purlins**

	Qty
2x8x12	82

**Lean-To Walk Door**

	Qty
Door Shims	1
Combo	1
3/0 6-Pnl STL LH	1

**Lean-To Rafter Blocking**

	Qty
2x6x12	7

**Lean-To Rafter Hardware**

	Qty
2x8 Joist	160
10.5" Bolts	36
14"	8
16"	8
20"	24
3/4" Nut	76
3/4" Wash	152

**Overhead Doors**

	Qty
Slide Latch	2
Punch Angle	3
2x8x10	4
2x8x14	2
2x10x14	2

**Roof Metal 1st Skid**

<b>Total Footage Of Roof Metal</b>	1205.33333
32-21'-4" Tuff Rib Panel White 01	32
32-16'-7" Tuff Rib Panel	32

**Wall Metal 2nd Skid**

<b>Total Footage Of Wall Metal</b>	1606.33333
2-28'-4" Tuff Rib Panel Bright Red 192	2
4-28'-0" Tuff Rib Panel	4
2-27'-0" Tuff Rib Panel	2
2-26'-0" Tuff Rib Panel	2

<b>Customer</b>	Joint Fire Protection Dist
<b>Address</b>	25266 Hwy 395 N
<b>City, State Zip</b>	Kettle Falls, WA 99141
<b>Phone</b>	360-402-7295

---

2-25'-0" Tuff Rib Panel	2
4-24'-0" Tuff Rib Panel	4
4-23'-0" Tuff Rib Panel	4
4-22'-0" Tuff Rib Panel	4
4-21'-8" Tuff Rib Panel	4
2-21'-6" Tuff Rib Panel	2
2-21'-0" Tuff Rib Panel	2
2-20'-0" Tuff Rib Panel	2
2-19'-0" Tuff Rib Panel	2
2-18'-0" Tuff Rib Panel	2
2-17'-6" Tuff Rib Panel	2
32-17'-0" Tuff Rib Panel	32
2-15'-0" Tuff Rib Panel	2
2-14'-0" Tuff Rib Panel	2
2-13'-0" Tuff Rib Panel	2
2-10'-6" Tuff Rib Panel	2
2-9'-6" Tuff Rib Panel	2
2-8'-6" Tuff Rib Panel	2
<b>Trims 10'-5" White 01</b>	1
Outside Corner TRZ2923	20
J-Metal TRZ2914	8
7.25 Open Jamb W/ Hem TR2908	4
W-Door Jamb TRZ2929	4
12 inch V-Rib Fascia TRZ2931	4
<b>Trims 13'-0" White 01</b>	1
U-Ridge Cap TRZ2926	4
Outside Corner TRZ2923	6
J-Metal TRZ2914	16
7.25 Open Jamb W/ Hem TR2908	8
<b>Trims 10'-5" Bright Red 19</b>	1
J-Metal TRZ2914	4
Base Metal TRZ2917	10
Inside Corner	2
<b>Trims 13'-0" Bright Red 19</b>	1
Base Metal TRZ2917	8
Inside Corner	2
<b>Fasteners White 01</b>	1
#10x1-1/2" Woodfast	2
#14x1" Woodtite	15
<b>Fasteners Bright Red 19</b>	1
#10x1" Woodfast	20

Customer	Joint Fire Protection Dist
Address	25266 Hwy 395 N
City, State Zip	Kettle Falls, WA 99141
Phone	360-402-7295

---

2-25'-0" Tuff Rib Panel	2
4-24'-0" Tuff Rib Panel	4
4-23'-0" Tuff Rib Panel	4
4-22'-0" Tuff Rib Panel	4
4-21'-8" Tuff Rib Panel	4
2-21'-6" Tuff Rib Panel	2
2-21'-0" Tuff Rib Panel	2
2-20'-0" Tuff Rib Panel	2
2-19'-0" Tuff Rib Panel	2
2-18'-0" Tuff Rib Panel	2
2-17'-6" Tuff Rib Panel	2
32-17'-0" Tuff Rib Panel	32
2-15'-0" Tuff Rib Panel	2
2-14'-0" Tuff Rib Panel	2
2-13'-0" Tuff Rib Panel	2
2-10'-6" Tuff Rib Panel	2
2-9'-6" Tuff Rib Panel	2
2-8'-6" Tuff Rib Panel	2
<b>Trims 10'-5" White 01</b>	1
Outside Corner TRZ2923	20
J-Metal TRZ2914	8
7.25 Open Jamb W/ Hem TR2908	4
W-Door Jamb TRZ2929	4
12 inch V-Rib Fascia TRZ2931	4
<b>Trims 13'-0" White 01</b>	1
U-Ridge Cap TRZ2926	4
Outside Corner TRZ2923	6
J-Metal TRZ2914	16
7.25 Open Jamb W/ Hem TR2908	8
<b>Trims 10'-5" Bright Red 19</b>	1
J-Metal TRZ2914	4
Base Metal TRZ2917	10
Inside Corner	2
<b>Trims 13'-0" Bright Red 19</b>	1
Base Metal TRZ2917	8
Inside Corner	2
<b>Fasteners White 01</b>	1
#10x1-1/2" Woodfast	2
#14x1" Woodtite	15
<b>Fasteners Bright Red 19</b>	1
#10x1" Woodfast	20